

Nucleo 3000

Design Air Curtain



The superb design and technical considerations make the Nucleo range of units a must for any entrance area. Its slim design and use of materials such as stainless steel or painted any RAL colour, ensures this type of unit is a leader in its class. Being competitive on cost and with various options for installation suspension systems, what more could a Designer ask for.

The Nucleo units are very popular with our customers when a luxurious and modern approach is needed to couple up with a high technological design.

The Nucleo unit can only be mounted in the horizontal position above a door opening but can facilitate different types of door openings and widths.

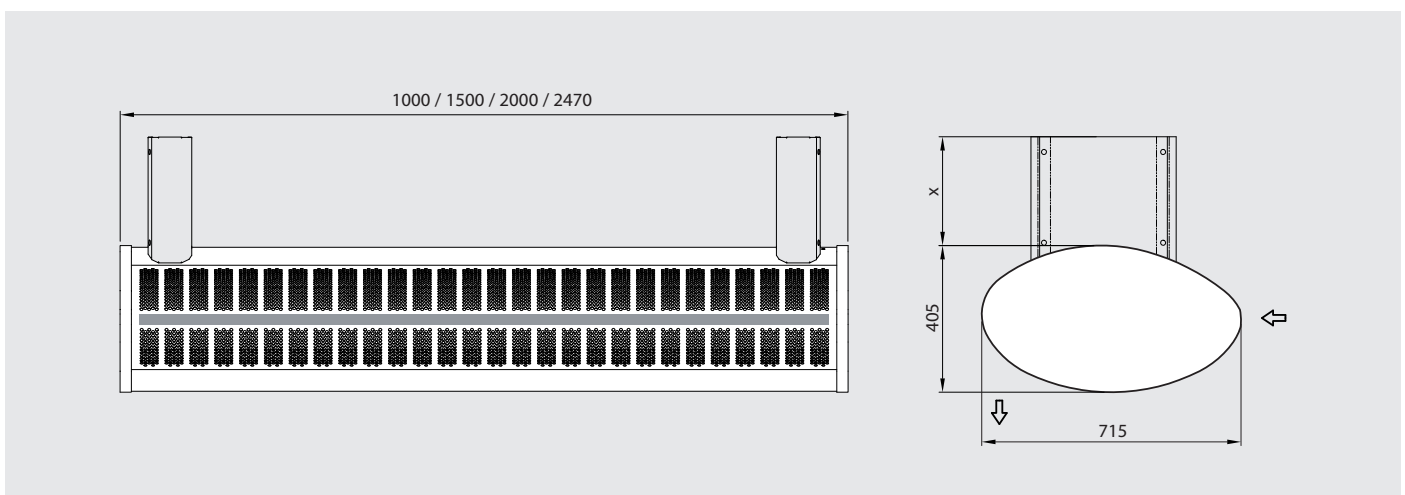

Technical data and recommended mounting height for different types of units.

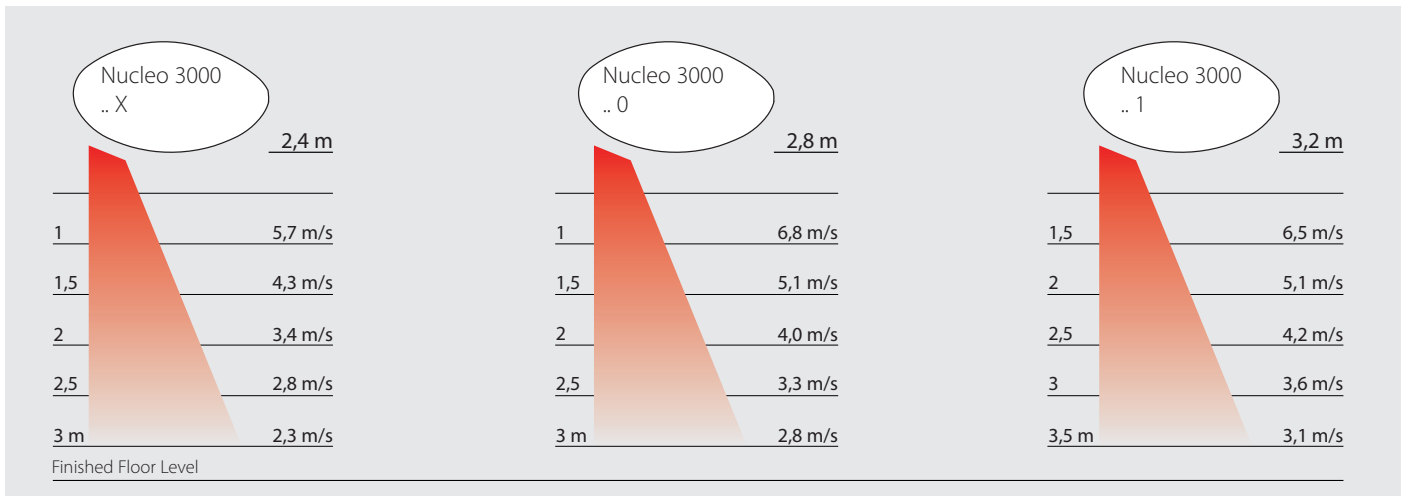

Technical data	Nucleo 3000 10X W(E)	Nucleo 3000 100 W(E)	Nucleo 3000 101 W(E)	Nucleo 3000 15X W(E)	Nucleo 3000 150 W(E)	Nucleo 3000 151 W(E)	Nucleo 3000 20X W(E)	Nucleo 3000 200 W(E)	Nucleo 3000 201 W(E)	Nucleo 3000 25X W(E)	Nucleo 3000 250 W(E)	Nucleo 3000 251 W(E)
Airflow Water coil [m³/h]	1800	2400	2900	2750	3500	4290	4080	4500	5740	5100	5500	7000
Airflow Electric coil [m³/h]	1800	2400	2900	2750	3500	4500	4080	4500	6000	5100	5500	7000
Water coil heating capacity [kW]	17,9	21,3	23,8	30,1	35,1	39,7	44,5	47,3	55,1	56	58,7	68,3
water 80/60°C / t _r =18°C water pressure drop [kPa]	5,9	8,1	9,9	12,2	16,1	20,1	13,1	14,8	19,5	9,7	10,6	11,9
Water Flow [m³/h]	0,8	1	1,1	1,3	1,5	1,7	1,9	2,1	2,4	2,4	2,6	3
Water Connection size [DN]	20	20	20	20	20	20	20	20	20	20	20	20
Electric coil ** Max. heating capacity [kW]	10	12,5	12,5	15,0	15,0	17,5	17,5	17,5	25	17,5	25	27,5
mains voltage [V]	400	400	400	400	400	400	400	400	400	400	400	400
Fan electrical data												
power [W]	510	770	720	770	1020	1080	1280	1280	1440	1530	1530	1800
current [A]	2,3	3,4	4,2	3,4	4,5	6,3	5,6	5,6	8,4	5,6	6,8	10,5
voltage [V]	230	230	230	230	230	230	230	230	230	230	230	230
Control type	Ditronic (Plus)											
Protection class	IP22	IP22	IP22	IP22	IP22	IP22	IP22	IP22	IP22	IP22	IP22	IP22
Sound level* dB (A)	58	58	60	60	59	62	60	60	63	61	61	64
Weight [kg]	68	69	69	86	86	88	124	126	128	152	152	158

* Acoustic pressure Lp(A) measurement taken at a distance of 3m from the unit source. ** Electric heating elements can be supplied in different ratings if required.

Suspension "A1"

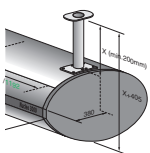

Suspension "A2"

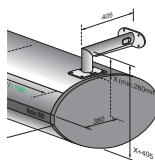

Suspension "B"

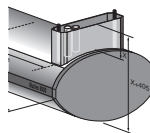

Suspension "C"

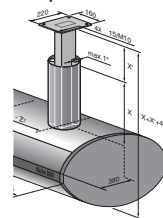

Suspension "D"

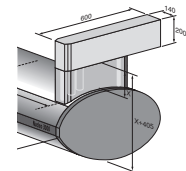

Accessories:

Electric (see page 50)

- Ditronic - LCD display controller
- Econ - controller
- DKMG - magnetic door contact
- Room sensor
- TP - room thermostat

Mechanical (see page 52)

- DKM - mechanical door contact
- 2 or 3 way valves - thermostatic or electrothermic valves (see pages 58)
- Suspension - under ceiling and wall mounted
- Flexible Connection hoses
- Spare filters - EU2